

## Single Ended Shear Beam

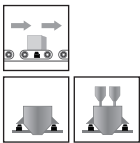
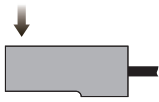

### Capacities

150lb, 250lb

### Features

- Single ended shear beam load cell
- Alloy steel construction
- High accuracy
- High stability
- Easy to install
- Protected against corrosion by nickel-plated treatment
- Suitable for hopper scales, tank & bin weighing, belt scales, etc.

### Schematic

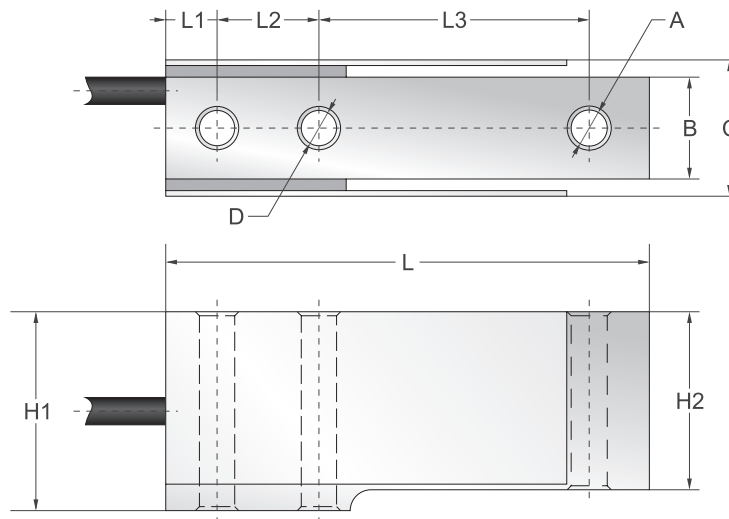
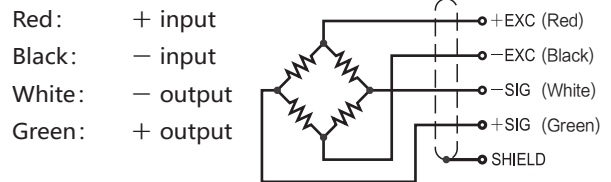

Capacities		L	L1	L2	L3	H1	H2	A	B	C	D
150lb	mm	60.3	6.4	12.7	33.7	24.8	22.2	Ø4.5	12.7	17	2×Ø4.4
250lb	mm	60.3	6.4	12.7	33.7	24.8	22.2	Ø4.5	19.1	23.5	2×Ø6.4

Specifications			
Rated Output	3.0mV/V±1%	Safe Temp. Range	-10°C to + 70°C
Zero Balance	±1% of rated output	Temp. Compensated	-10°C to + 40°C
Creep after 30 minutes	±0.03% of rated output	Safe Overload	150%
Nonlinearity	±0.03% of rated output	Input Impedance	387 ohm ± 20 ohm
Hysteresis	±0.03% of rated output	Output Impedance	350 ohm ± 5 ohm
Repeatability	±0.03% of rated output	Insulation Resistance	≥5000 M ohm (50V DC)
Temp. effect on output	≤0.002% of applied output/°C	Rated Excitation	10V DC/AC
Temp. effect on zero	≤0.002% of rated output/°C	Maximum Excitation	15V DC/AC
Wire Length	1.5m	Wire Material	Red(+E) Black(-E) White(-S) Green(+S)