

## Single Ended Shear Beam

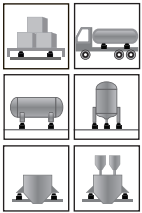

### Capacities

10000kg, 15000kg, 20000kg

### Features

- Single ended shear beam load cell
- Alloy steel construction
- High accuracy
- High stability
- Unique "blind" loading hole
- Easy to install
- Protected against corrosion by nickel-plated treatment
- Suitable for floor scales, blending & mixing systems and batching systems, etc.

### Schematic

Red: + input  
 Black: - input  
 White: - output  
 Green: + output

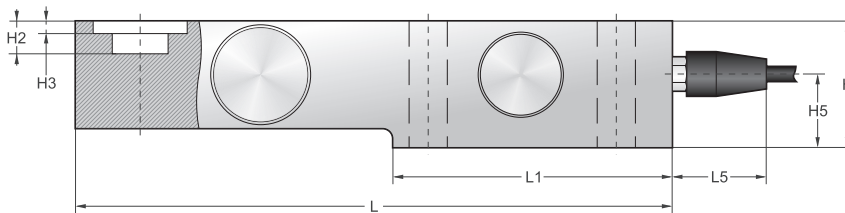
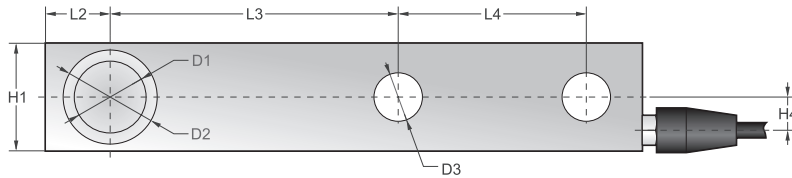
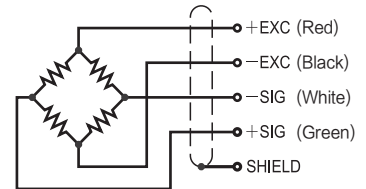

Capacities		L	L1	L2	L3	L4	L5	H	H1	H2	H3	H4	H5	D1	D2	D3
10t	mm	279	133	32	140	82	32	67	60	20	8.5	21.5	37	Ø32	Ø48	2×Ø28
15t~20t	mm	318	153	38	159	89	32	82.5	70	24	9.5	25.5	47.5	Ø38	Ø54	2×Ø34

### Load Cell Specifications

Rated Output	2.0mV/V ±0.1%	Safe Temp. Range	-10°C to + 70°C
Zero Balance	±1% of rated output	Temp. Compensated	-10°C to + 40°C
Creep after 30 minutes	±0.03% of rated output	Safe Overload	150%
Nonlinearity	±0.03% of rated output	Input Impedance	387 ohm ± 20 ohm
Hysteresis	±0.03% of rated output	Output Impedance	350 ohm ± 5 ohm
Repeatability	±0.03% of rated output	Insulation Resistance	≥5000 M ohm (50V DC)
Temp. effect on output	≤0.002% of applied output/°C	Rated Excitation	10V DC/AC
Temp. effect on zero	≤0.002% of rated output/°C	Maximum Excitation	15V DC/AC
Wire Length	9.5m(10~15t)/13m(20t)	Wire Material	Red(+ E) Black(- E) White(- S) Green(+ S)