

Pancake Type

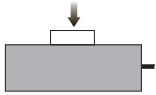

Capacities

50t, 100t

Features

- Pancake type load cell
- Alloy steel construction
- High accuracy
- High stability
- Easy to install
- Protected against corrosion by nickel-plated treatment
- Suitable for testing machine

Schematic

Red: + input
 Black: - input
 White: - output
 Green: + output

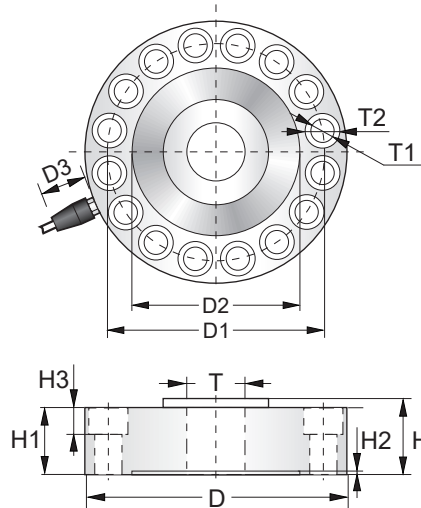
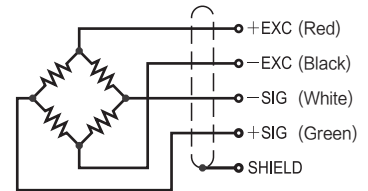

Capacities		D	D1	D2	D3	H	H1	H2	H3	T	T1	T2
50t	mm	Ø234	Ø194	Ø150	32	60	55	4.7	22	M52x2-6H	16xØ21	16xØ32
	inch	Ø9.2	Ø7.6	Ø5.9	1.26	2.4	2.2	0.2	0.9		16xØ0.8	16xØ1.3
100t	mm	Ø258	Ø218	Ø174	32	60	57	3	22	M76x2	16xØ21	16xØ32
	inch	Ø10.2	Ø8.6	Ø6.9	1.26	2.4	2.24	0.12	0.9		16xØ0.8	16xØ1.3

Specification

Rated Output	3.0mV/V ±0.25%	Safe Temp. Range	-20°C to + 60°C
Zero Balance	±1% of rated output	Temp. Compensated	-10°C to + 40°C
Creep after 30 minutes	±0.03% of rated output	Safe Overload	150%
Nonlinearity	±0.1% of rated output	Input Impedance	770±10 ohm(50t)/385±5 ohm(100t)
Hysteresis	±0.1% of rated output	Output Impedance	700±5 ohm(50t)/350±3 ohm(100t)
Repeatability	±0.02% of rated output	Insulation Resistance	≥5000 M ohm (50V DC)
Temp. effect on output	≤0.0015% of applied output/°C	Rated Excitation	10V DC/AC
Temp. effect on zero	≤0.0026% of rated output/°C	Maximum Excitation	15V DC/AC
Wire Length	3m	Wire Material	TPR cable
Wire Specification	24AWG	Wire Type	Shielding net four core