

Pancake Type

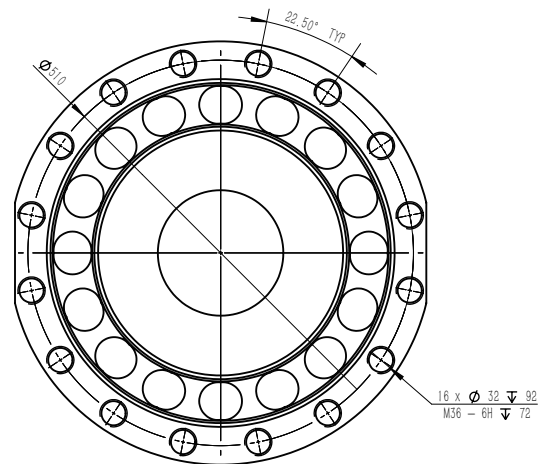
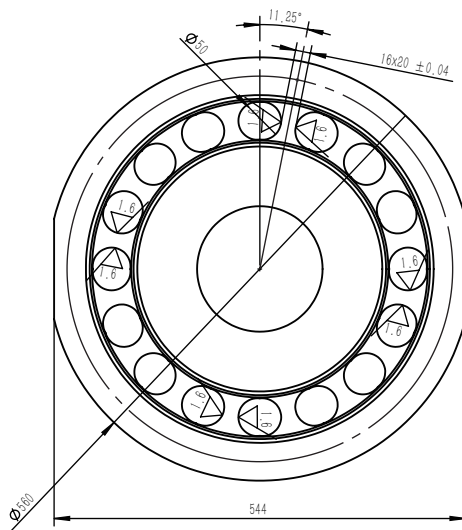
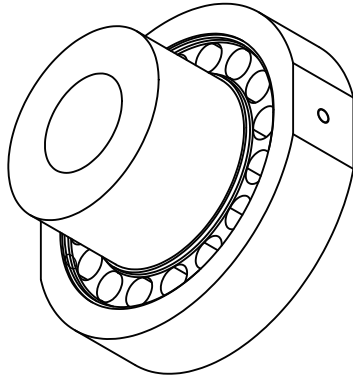

Capacities

500t

Features

- Pancake type load cell
- Alloy steel construction
- High stability
- Environmental Protection: IP65
- Easy to install
- Protected against corrosion by nickel-plated treatment
- Suitable for testing machine, big bin & hopper scales, etc.

Schematic

- Red: + input
- Black: - input
- White: - output
- Green: + output

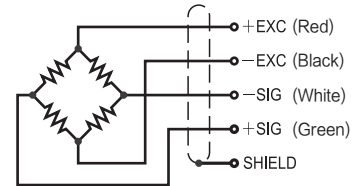

Specification

Rated Output	2.0mV/V ±0.2mV/V	Safe Temp. Range	-20°C to + 60°C
Zero Balance	±0.015mV/V	Temp. Compensated	-10°C to + 40°C
Creep after 30 minutes	±0.05% of load	Max. Safe Overload(central loading)	200% of R.C
Nonlinearity	±0.2% of R.O	Input Impedance	770 ohm ± 10 ohm
Hysteresis	±0.2% of R.O	Output Impedance	700 ohm ± 5 ohm
Repeatability	±0.1% of R.O	Insulation Resistance	≥5G ohms (50V DC)
Temp. effect on output	≤0.015% of applied output/°C	Wire Specification	4X26AWG
Temp. effect on zero	≤0.026% of rated output/°C	Wire Material	PU
Wire Length	5m	Wire Structure	Braid shield