

Pancake Type



Capacities

1t

Features

- Pancake type load cell
- Alloy steel construction
- High accuracy
- High stability
- Low profile
- Easy to install
- Protected against corrosion by nickel-plated treatment
- Suitable for testing machine, truck scales and big bin & hopper scales, etc.

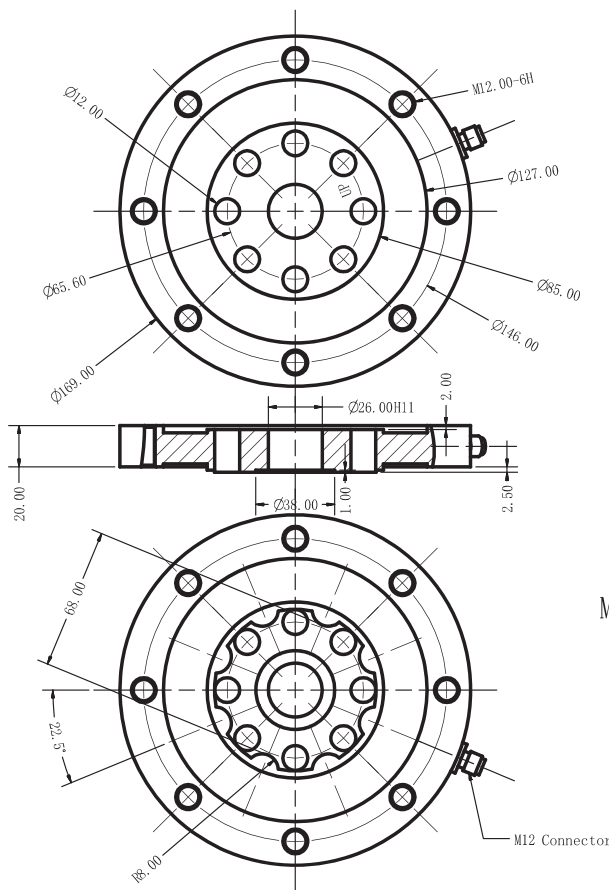

- 1 S+ channel 1
- 2 EX+ (V+)
- 3 S- channel 1
- 4 S+ channel 2
- 5 EX- (V-)
- 6 S- channel 2
- 7 NC
- 8 NC

M12 Female Socket (8PIN)

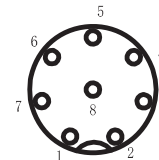

Specifications			
Rated Output (R.O)	0.6 mV/V (Dual signal)	Insulation Resistance	≥5000 M ohm (50V DC)
Zero Balance	±5% of R.O	Recommend Exc Voltage	10 V DC/AC
Comprehensive Error	±1% of R.O	Safe Overload	150% FS
Safe Temp. Range	-20°C~70°C	Material Quality	Alloy steel construction
Storage Temperature	-40°C~80°C	IP	IP66
Bridge Impedance	350 ohm		